

Alternative installation guide: CaberFix Joint&Joist + CaberFix Tape + D3 PVA

CaberDek can be installed with our CaberFix range that's ideal for the complete installation job. When applied in accordance with the installation instructions, CaberDek has full BBA approval for 60 days exposure*.

*When installed according to manufacturer's instructions

CaberFix Joint&Joist

Will bond to a wide variety of materials and can also be used to provide a 100% guaranteed waterproof seal in tongue and groove joints between boards.

CaberFix Tape

For sealing CaberDek perimeters to walls and for sealing joints during construction phases.

D3 PVA

For sealing and fixing tongue and groove flooring.



CaberDek with CaberFix Joint&Joist + CaberFix Tape + D3 PVA step by step installation instructions

Step 1. Adhesive I-joist application

Apply one continuous ~6mm bead of CaberFix Joint&Joist adhesive to the top of the joist or I-joist, using a skeleton gun. Use CaberFix Joint&Joist adhesive on joists and noggins in the area that is about to be directly laid.

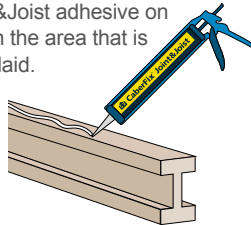

Step 2. Perimeter panel fixing

Panels should be fixed at perimeter using annular ringshank nails or screws at 200-300mm centres. Fix flush or just below panel surface 25mm from edge of board.

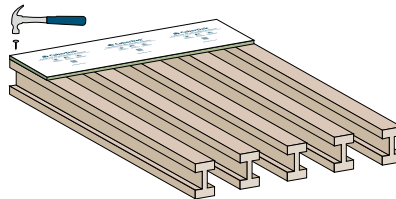

Step 3. Adhesive T&G application

A liberal application of D3 PVA adhesive should be made to both the tongue and groove of the profile joint of each panel to ensure that the entire joint is bonded.

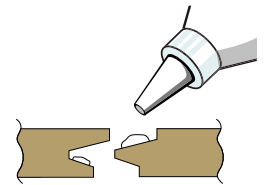

Step 4. Panel fixings

Continue laying boards in a staggered format. Panels may be secretly nailed through the tongue at T&G joints. For optimum performance we recommend a minimum of 5 mechanical fixings per 22 x 2400 x 600mm board when fitted at 600mm centres. i.e. 1 fixing per joist.

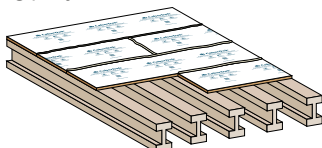

Step 5. Taping

Immediately after a run of panels have been fixed, all board joints, nail runs and exposed edges around the perimeter should be sealed using CaberFix Tape.

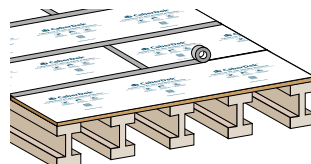

Step 6. Clean down

When all construction and decoration work is complete and the building is weather tight, the deck should be cleaned down: Remove the peel-off film by pulling slowly but firmly from the short end.

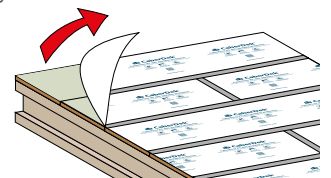

For advice on the best product for your specific application, please contact West Fraser on: **01786 819 225** or visit: **CaberFloor.com**



33898